

ARCHITECTURE LINEAR LIGHT

Installation Guide

!

WARNING

PLEASE FIND A QUALIFIED ELECTRICIAN FOR INSTALLATION. Please read the instructions before installation and use

- To reduce the risk of death, personal injury, or property damage from fire, electric shock, falling parts, cuts/abrasions, and other hazards, read all warnings and instructions included with and the fixture box and fixture labels.
- Before installing, servicing, or performing routine maintenance upon this equipment, follow these general precautions.
- Commercial installation, service, and maintenance of luminaires should be performed by a qualified licensed electrician.
- If you are unsure about the installation or maintenance of the luminaires, consult a qualified licensed electrician. Please abide by all relevant country, regional, and local code requirements and regulations when installing this luminaire. Wiring must be in accordance with NEC and all applicable local codes.
- DO NOT INSTALL DAMAGED PRODUCT!** This luminaire has been properly packed so that no parts should have been damaged during transit. Inspect to confirm. Any part damaged or broken during or after assembly should be replaced.
- Do not make or alter any holes unnecessarily in an enclosure of wiring or electrical components during the installation.
- Turn off electrical power at the fuse or circuit breaker box before wiring fixture to the building power.
- Verify that supply voltage is correct by comparing it with the luminaire label information. Do not install with supply voltage that exceeds the rated input voltage of the luminaire.

CAUTION

- Do not install in wet locations. For dry and damp use only.
- The electrical rating of this product is 120-277V. Installer must confirm that there is 120-277V at the fixture before installation.
- Under no circumstances can the lighting fixture be covered with heat insulation gasket or similar materials.

SUSPENSION MOUNT INSTALLATION (STAND ALONE UNIT)

1

Octagon J-Box
(By Others)

2

J-Box Mounting
Bracket

3

J-Box Mounting
Screws 8-32 (*2)

4

Power Canopy

5

Cable Holder

6

Thread Buckle

7

Power Cord

8

Aircraft Bolts

9

Mounting Bolt

10

Canopy

11

Anchor
Screw PA4*30

12

Thread Buckle

13

Wiring Cap(*5)

14

Cable tie(*3)

Size

L

W

H

Installation spacing
suggestion

2FT

23.82'

2.48'

3.15'

21.65'

4FT

47.44'

2.48'

3.15'

45.28'

6FT

71.06'

2.48'

3.15'

68.90'

8FT

94.67'

2.48'

3.15'

92.52'

WIRING DIAGRAM

LINE

NEUTRAL

GREEN

DIM (+)

DIM (-)

BLACK

WHITE

GROUND

VIOLET

PINK

1

2

3

4

5

6

7

8

9

10

11

12

13

14

Pendant installation

12

Knock out the cable hole
before installation

5

Connect the AC power cord
with the inner linkable cable

14

Cable Tie

SURFACE MOUNT INSTALLATION (STAND ALONE UNIT)

1

J-Box
Cover plate

2

Aircraft Bolts

3

UP Lock Collar(*2)

4

Down Lock Collar(*2)

5

M4*8 screw(*2)

6

Thread Buckle

7

J-Box Mounting
Screws 8-32(*2)

8

Power Cord

Size

L

W

H

Installation Hole
spacing suggestion

2FT

23.82'

2.48'

3.15'

14.17'

4FT

47.44'

2.48'

3.15'

37.80'

6FT

71.06'

2.48'

3.15'

61.42'

8FT

94.67'

2.48'

3.15'

85.03'

1

Drilling holes for ceiling installation.

2

Ceiling installation.

3

Installation method of aircraft clip

4

Suction top column installation.

5

Ceiling installation.

WALL MOUNT INSTALLATION (STAND ALONE UNIT)

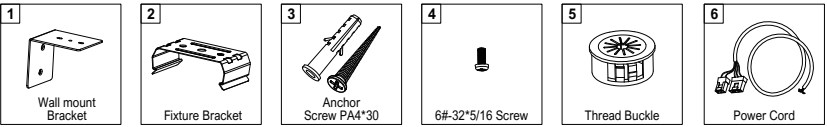

Size	L	W	H	Installation spacing suggestion
2FT	23.82'	2.48'	3.15'	13.78'
4FT	47.44'	2.48'	3.15'	41.33'
6FT	71.06'	2.48'	3.15'	64.96'
8FT	94.67'	2.48'	3.15'	88.58'

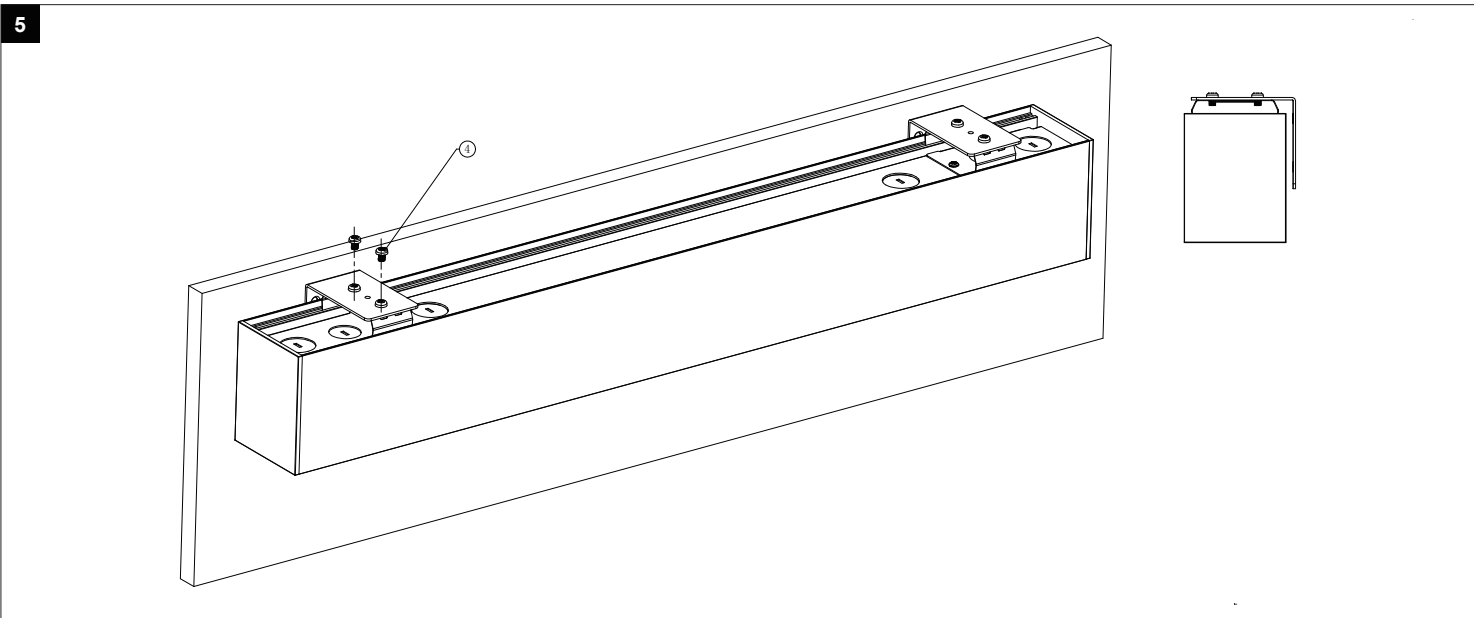
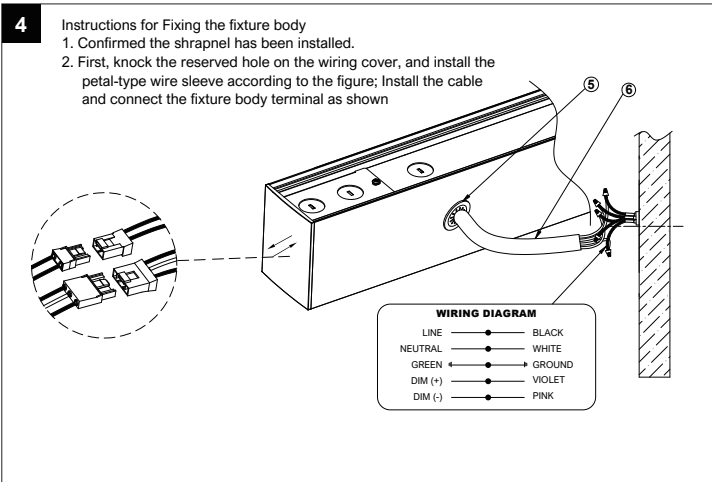
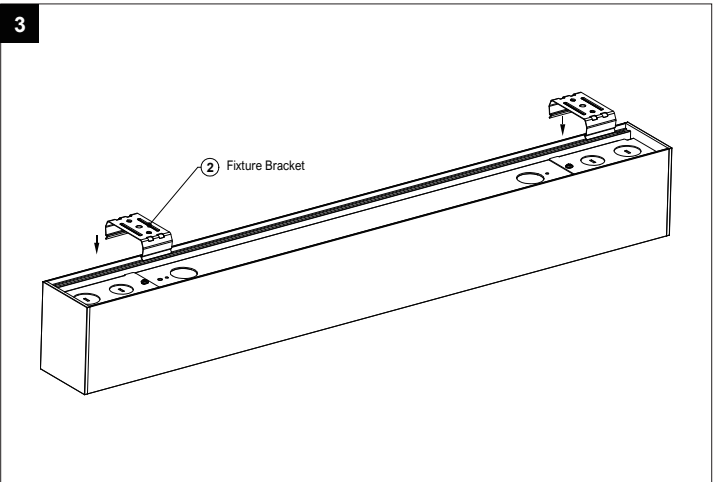
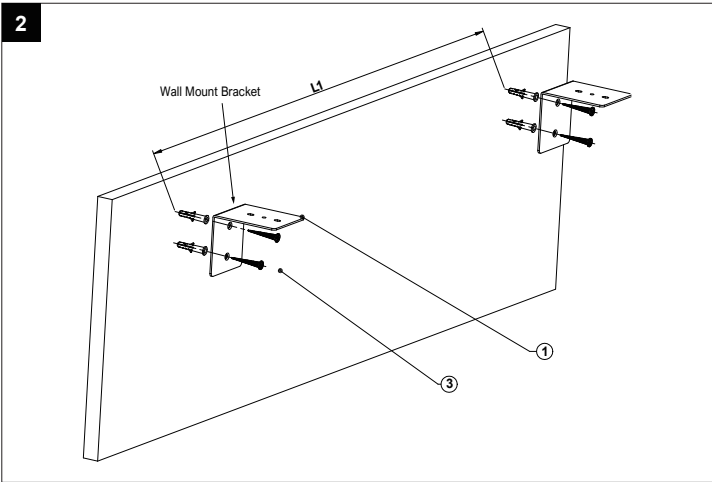
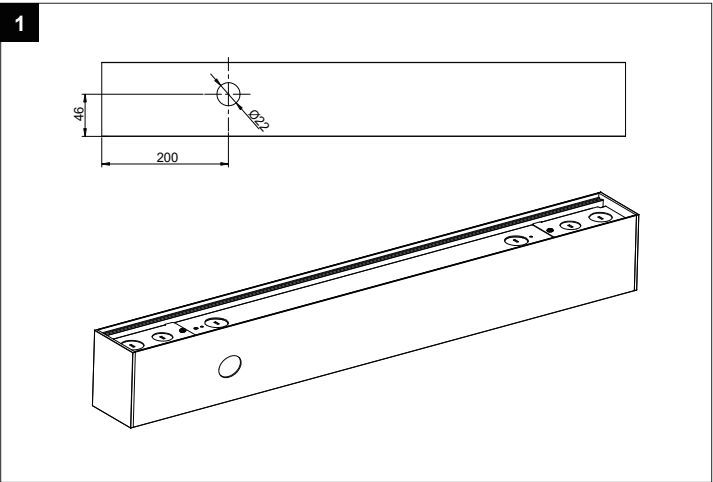

UP LIGHT INSTALLATION

1. Use a screwdriver to open the cover of the connection as shown in the diagram.
2. Install the up light module and finish the wiring.
3. 2FT and 4FT connections methods: Insert the UP LED 1 terminal wire, connection completed.
4. 6FT and 8FT connections wiring methods : Insert the UP LED1 terminal wire, then insert the UP LED 2 terminal wire, connection completed.

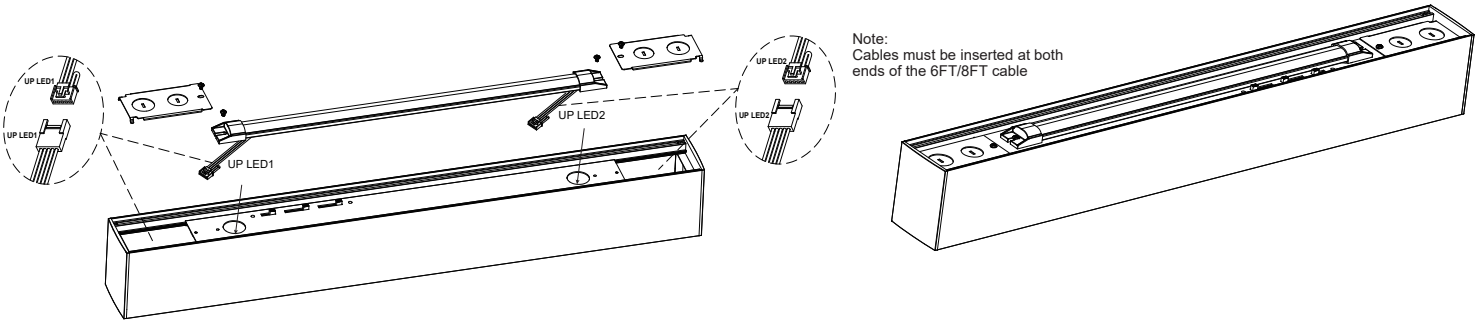

LINK PATTERN INSTALLATION

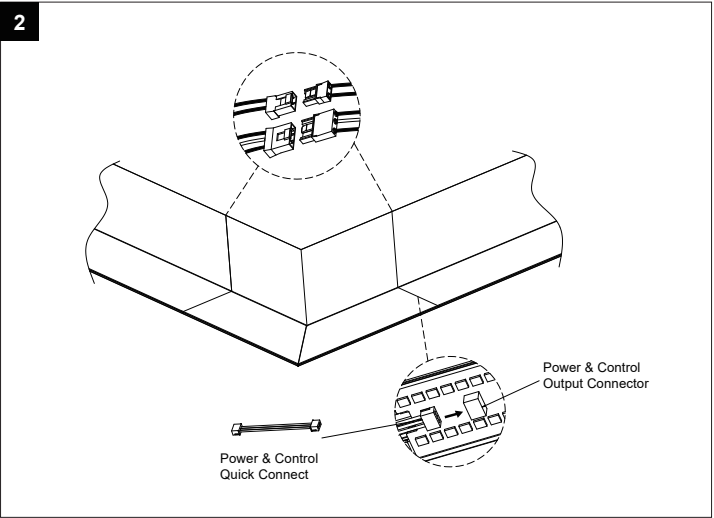
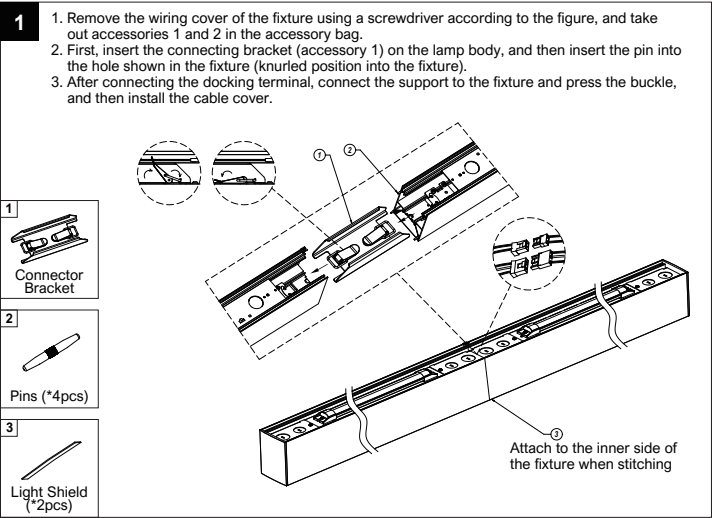
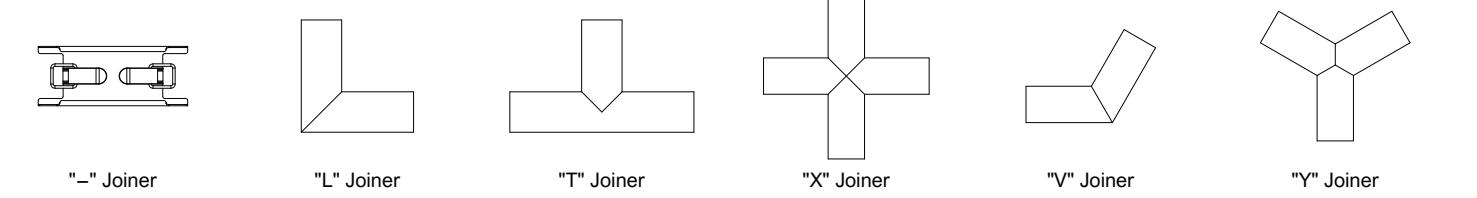

DIFFUSER ACCESSORIES (OPTIONAL)

Optional continuous rolling lens which can reach seamless continue runs up to 100' is available.

